

Page 1/2

Ordered by:
STUART BREEDING

Date of Field Work:
July 15, 2021

TANKING SURVEY

25850 L Road
Circleville, Ks 66416
(785) 924-3367

Plat of Survey
Andrew P. Tanking
Licensed Land Surveyor

STATE OF KANSAS, Marshall County, ss:

Report of Survey on a 4.00 acre parcel in the Southwest Fractional Quarter of Section 18, Township 1 South, Range 7 East of the 6th. P.M., Marshall County, Kansas.

I, Andrew P. Tanking, Kansas Land Surveyor #1314, performed this survey on July 15, 2021, upon the request of Stuart Breeding.

Objective of Survey:

The objective of this survey was to permanently establish the boundary of a new 4.00 acre parcel in the Southwest Fractional Quarter of Section 18, Township 1 South, Range 7 East of the 6th. P.M., Marshall County, Kansas, and to prepare a legal description for said parcel.

Method of Establishment:

SECTION 18-1-7: SW Corner: Existing 1/2" Capped Bar "PESCHEL LS 1385" Found from Reference Report by Peschel, 5/21/09.
S 1/4 Corner: 1/2" x 24" Capped Bar "A.P.T. LS 1314" Set using Single Proportion Method between SW and SE corners.
SE Corner: Existing 1/2" Capped Bar "KDOT Surveys" Found from Reference Report by Peschel, 5/09/19.

Description of 4.00 Ac. Parcel:

A parcel of land located in the Southwest Fractional Quarter of Section 18, Township 1 South, Range 7 East of the 6th P.M., Marshall County, Kansas, described by Andrew P. Tanking, PS 1314, on July 15, 2021, as follows: Commencing at the Southwest corner of said Section 18, Thence North 90°00'00" East along the South line of said Southwest Fractional Quarter 1212.16 feet to the True POINT OF BEGINNING; Thence North 0°00'00" East 359.25 feet, Thence North 90°00'00" East 485.00 feet, Thence South 0°00'00" West 359.25 feet to the South line of said Southwest Fractional Quarter, Thence South 90°00'00" West along said South line 485.00 feet to the POINT OF BEGINNING, containing 4.00 acres, and subject to any easements of record.

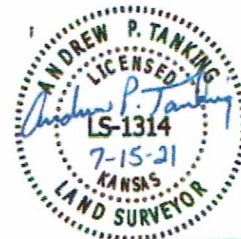

Andrew P. Tanking, PLS 1314
25850 L Road
Circleville, Ks 66416
(785) 924-3367

Certificate of Report:

I hereby certify that a survey of the above described property was made by me or under my direct supervision on July 15, 2021, and is correct to my belief and knowledge.

Certificate of Review:

I, Rob Peschel, Kansas Land Surveyor #1385, have reviewed and do hereby certify that the attached plat and survey report meets all the technical requirements for filing. I have not performed any field surveys to verify the accuracy of the basic information.

IN WITNESS WHEREOF, I hereto set my hand, this _____ day of _____, 2021.

Rob Peschel, PLS #1385

STATE OF KANSAS, Marshall County, ss:

Filed on the _____ day of _____ A.D., 2021,

County Engineer/Surveyor

A parcel of land located in the Southwest Fractional Quarter of Section 18, Township 1 South, Range 7 East of the 6th P.M., Marshall County, Kansas, described by Andrew P. Tanking, PS 1314, on July 15, 2021, as follows: Commencing at the Southwest corner of said Section 18, Thence North 90°00'00" East along the South line of said Southwest Fractional Quarter 1212.16 feet to the True POINT OF BEGINNING; Thence North 0°00'00" East 359.25 feet, Thence North 90°00'00" East 485.00 feet, Thence South 0°00'00" West 359.25 feet to the South line of said Southwest Fractional Quarter, Thence South 90°00'00" West along said South line 485.00 feet to the POINT OF BEGINNING, containing 4.00 acres, and subject to any easements of record.