

# Soils Map

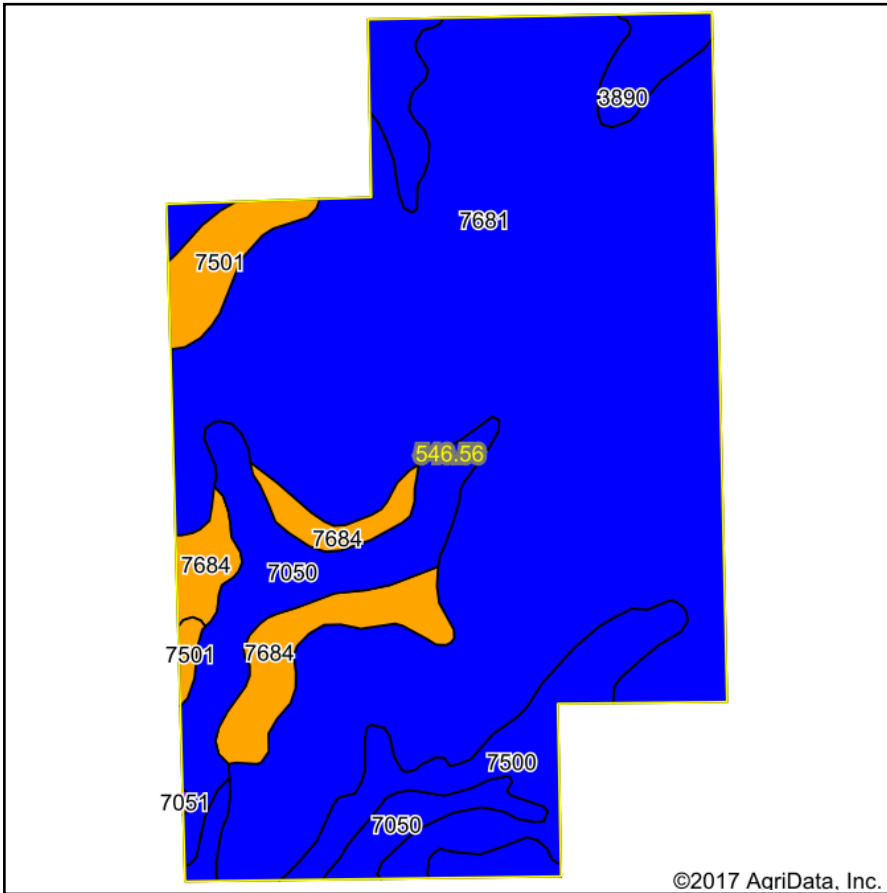

Soils data provided by USDA and NRCS.

©2017 AgriData, Inc.

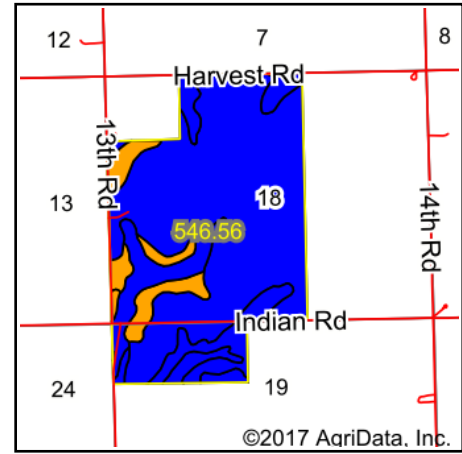

©2017 AgriData, Inc.







State: **Kansas**  
 County: **Marshall**  
 Location: **18-2S-8E**  
 Township: **Franklin**  
 Acres: **546.56**  
 Date: **9/13/2017**

**Midwest Land**   
**and Home**

Maps Provided By:  
  
 CUSTOMIZED ONLINE MAPPING  
 © AgriData, Inc. 2017 [www.AgriDataInc.com](http://www.AgriDataInc.com)



## Area Symbol: KS117, Soil Area Version: 17

Code	Soil Description	Acres	Percent of field	Non-Irr Class Legend	Non-Irr Class *c	Irr Class *c	Grain sorghum	Winter wheat	Alfalfa hay	Corn	Soybeans	
7681	Wymore silty clay loam, 1 to 3 percent slopes	386.95	70.8%		Ile	Ile						
7050	Kennebec silt loam, occasionally flooded	52.17	9.5%		IIw					114	38	
7500	Pawnee clay loam, 1 to 4 percent slopes	40.08	7.3%		Ile	IIIe						
7684	Wymore silty clay loam, 3 to 6 percent slopes, eroded	32.42	5.9%		IIIe	IVe						
3890	Ladysmith silty clay loam, 0 to 1 percent slopes	20.50	3.8%		IIs	IIs						
7501	Pawnee clay loam, 4 to 8 percent slopes, eroded	14.30	2.6%		IIIe		60	26	3	49	21	
7051	Kennebec silt loam, frequently flooded	0.14	0.0%		Vw		68	38				
<b>Weighted Average</b>								<b>1.6</b>	<b>0.7</b>	<b>0.1</b>	<b>12.2</b>	<b>4.2</b>

\*c: Using Capabilities Class Dominant Condition Aggregation Method

Soils data provided by USDA and NRCS.