

# Soils Map

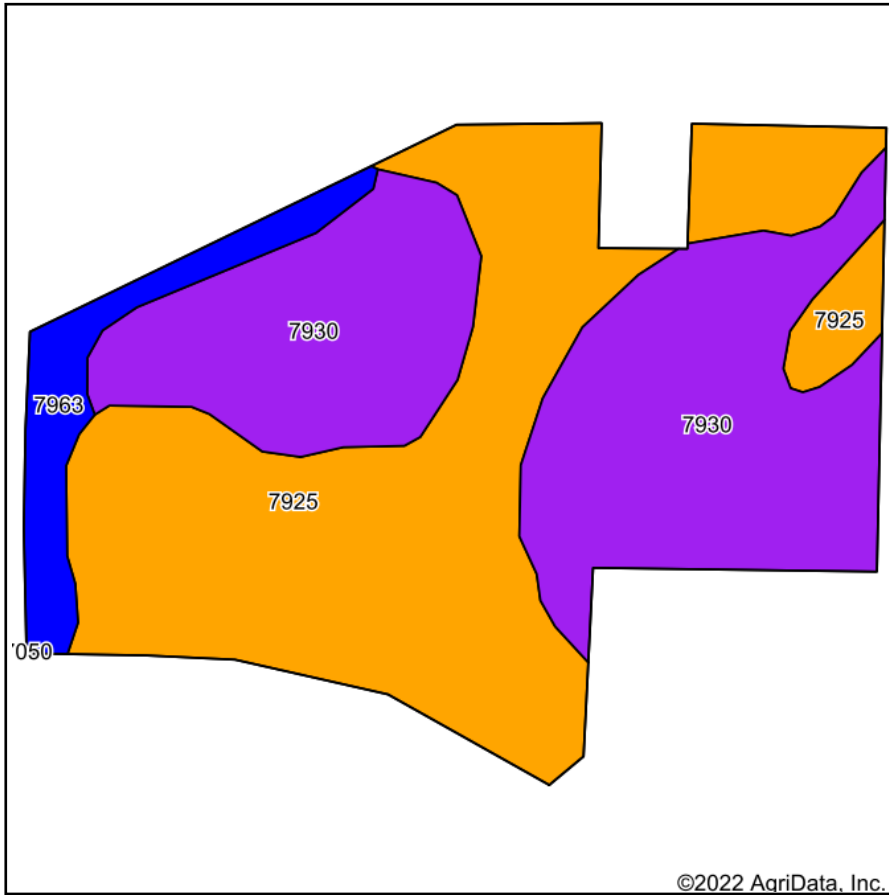

Soils data provided by USDA and NRCS.

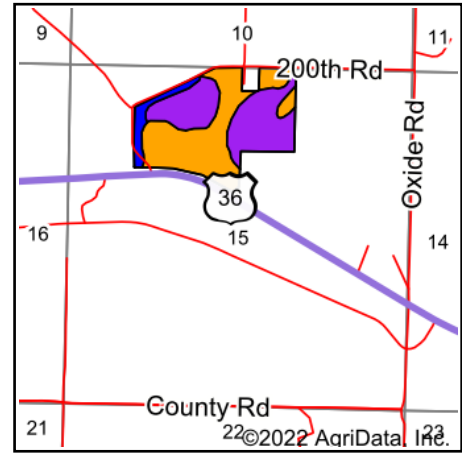

State: **Kansas**  
 County: **Doniphan**  
 Location: **15-3S-21E**  
 Township: **Center**  
 Acres: **78.18**  
 Date: **11/22/2022**



Maps Provided By:



© AgriData, Inc. 2021

www.AgriDataInc.com



Area Symbol: KS043, Soil Area Version: 23

Code	Soil Description	Acres	Percent of field	Non-Irr Class Legend	Non-Irr Class *c	Range Production (lbs/acre/yr)	Bromegrass alfalfa AUM	Bromegrass alfalfa hay Tons	Corn Bu	Grain sorghum Bu	Kentucky bluegrass AUM	Oats Bu	Smooth bromegrass AUM	Soybeans Bu	Wheat Bu
7925	Contrary-Monona silt loams, 9 to 17 percent slopes, eroded	38.65	49.4%		Ile	3550	7	4	86	66	3	51	4	32	
7930	Contrary-Pohocco silt loams, 17 to 30 percent slopes, eroded	34.24	43.8%		Vle	3700	3	2					1		
7963	Monona silt loam, 1 to 4 percent slopes, bench	5.29	6.8%		Ile	3940	9	5	128	77	4	70	5	43	
<b>Weighted Average</b>						<b>4.25</b>	<b>3642.1</b>	<b>5.4</b>	<b>3.2</b>	<b>51.2</b>	<b>37.8</b>	<b>1.8</b>	<b>29.9</b>	<b>2.8</b>	<b>18.7</b>

\*n: The aggregation method is "Weighted Average using all components"

\*c: Using Capabilities Class Dominant Condition Aggregation Method

Soils data provided by USDA and NRCS.