

Wetlands Map

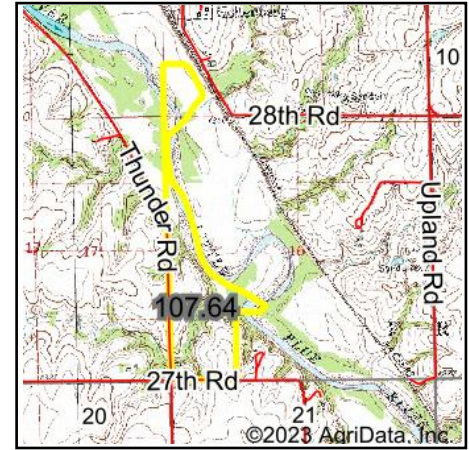

State: Kansas
Location: 16-1S-4E
County: Washington
Township: Franklin
Date: 5/22/2023



Maps Provided By:

 CUSTOMIZED ONLINE MAPPING
 © AgriData, Inc. 2023 www.AgriDataInc.com



0ft 1447ft 2895ft

Classification Code	Type	Acres
R2UBG	Riverine	9.33
R2USA	Riverine	2.02
R2USC	Riverine	1.44
R4SBC	Riverine	1.22
R5UBH	Riverine	0.96
PFOA	Freshwater Forested/Shrub Wetland	0.07
Total Acres		15.04

Data Source: National Wetlands Inventory website. U.S. DoI, Fish and Wildlife Service, Washington, D.C. <http://www.fws.gov/wetlands/>